

# JEFFERSON ROAD BRIDGE

## BRIDGE No: PLA-CR 157-3.33

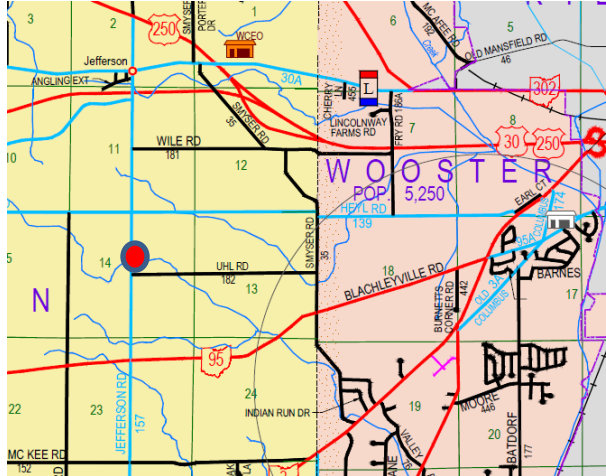

SOUTH APPROACH



ELEVATION

LOCATION: Jefferson Road over Br. of Killbuck Creek; 0.4 Mile South of Heyl Rd. (CR 139)

EXISTING STRUCTURE: Single-Span Concrete Slab and Spread Footing Concrete Abutments  
Deck Width = 20' Toe to Toe of Concrete Railing

PROPOSED STRUCTURE: 14'-0" x 8'-7" x 45'-0" Aluminum Plate Pipe Arch Culvert.  
Deck Width = 24'-0" Face to Face Railing

PROJECT FINANCING: Force Account (Local K-Funds; Auto License & Gas Tax Funds)

ESTIMATED COST: \$99,630.00

REASON: Structurally Deficient and Posted Load Limit

CONTRACTOR: County Crew