

NONPARIEL ROAD BRIDGE

BRIDGE No: FRA-TR202-2.48

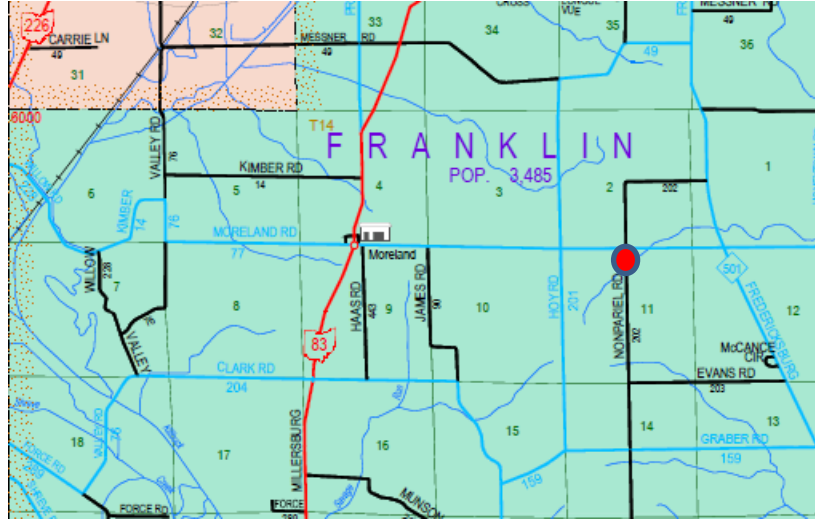

NORTH APPROACH



ELEVATION

LOCATION: Nonpariel Road; 0.2 mile South of Moreland Road over North Br. of Salt Creek

EXISTING STRUCTURE: 13'-8" Single Span Slab Bridge Supported on Concrete Abutments
Deck Width = 22.8' Face to Face of Railing

PROPOSED STRUCTURE: 10'x5'x40'-0" Box Culvert
Deck Width = 24'-0" Face to Face of Railing

PROJECT FINANCING: Force Account (**Local K-Funds**)

REASON: Structurally Deficient

CONTRACTOR: County Crew