

# PARAMENTER ROAD BRIDGE

## BRIDGE No: CAN-TR347-2.20

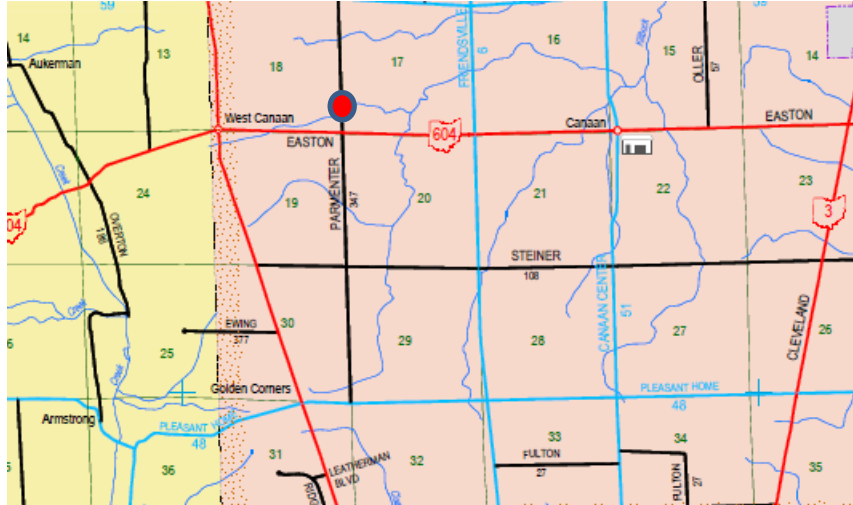

SOUTH APPROACH



ELEVATION

LOCATION: Parmenter Road; 0.1 Mile North of S.R. 604 over Br. of Killbuck Creek.

EXISTING STRUCTURE: 12' Single Clear Span Wood Deck on Steel Beams, Supported on Concrete Abutments  
Deck Width = 15' Face to Face of Railing

PROPOSED STRUCTURE: 14' X 5' X 44'-0" Precast Reinforced Concrete Box Culvert  
Deck Width = 24'-0" Face to Face of Railing

PROJECT FINANCING: Force Account (**Local K-Funds**)

REASON: Structurally Deficient

CONTRACTOR: County Crew