

DALTON-FOX LAKE ROAD BRIDGE

BRIDGE No: BAU-CR32-1.07

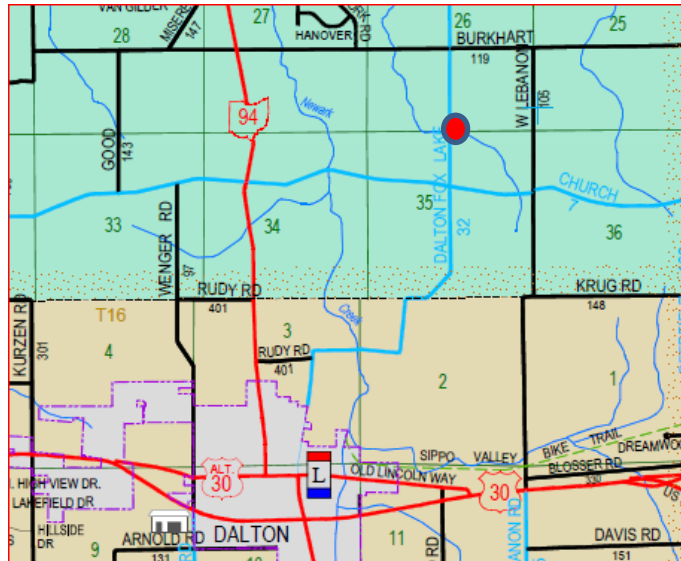

SOUTH APPROACH



ELEVATION

LOCATION: Dalton-Fox lake Road; 0.3 Mile North of C.R. 7 over Br. of Newman Creek.

EXISTING STRUCTURE: 13' Single Clear Span Concrete Slab on Concrete Gravity Abutments
Deck Width = 20' Face to Face of Concrete Railing

PROPOSED STRUCTURE: Replace Bridge Deck with County Precast Beam Superstructure
Deck Width = 24'-0" Face to Face of Railing

PROJECT FINANCING: Force Account (**Local K-Funds**)

REASON: Structurally Deficient

CONTRACTOR: County Crew