

SMITHVILLE WESTERN ROAD CULVERT

CULVERT No: WAY-CR86-1.595

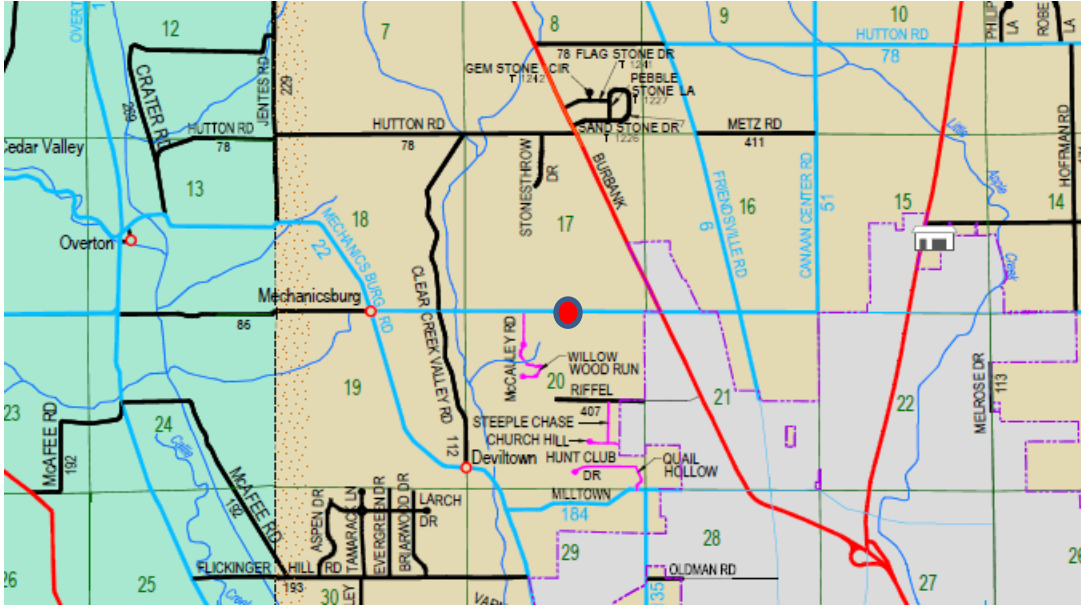

WEST APPROACH



ELEVATION

LOCATION: Smithville Western Road; 0.50 Mile West of Burbank Rd. (SR 83) Over Branch of Clear Creek.

EXISTING STRUCTURE: 5' x 5' Sandstone Slab Over Sandstone Abutments; Roadway Width =20'; F/F Guardrail =27'-0"

PROPOSED STRUCTURE: 7' x 6' x 52'-0" Precast Reinforced Concrete Box Culvert
Roadway Width =20'-0" Face to Face Guardrail =27'-0"

PROJECT FINANCING: Force Account (**Local K-Funds**)

REASON: Structurally Deficient

CONTRACTOR: County Crew