

# FINLEY ROAD BRIDGE

## BRIDGE No: CHE-TR 89-0.36

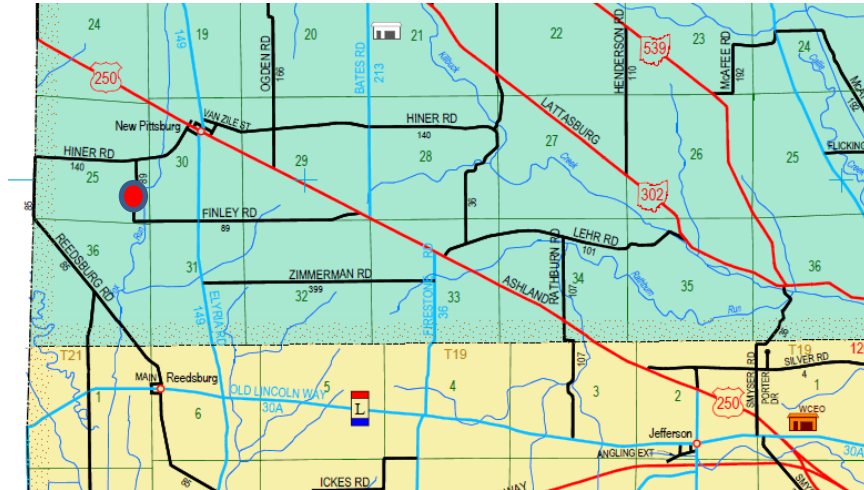

SOUTH APPROACH



ELEVATION

LOCATION: Finley Road; 1/4 mile South of Hiner Rd.

EXISTING STRUCTURE: 10'-0" Single Span Wood Deck on Steel Beams, Supported on Railroad Rail Abutments  
Deck Width = 13' Face To Face Of Railing

PROPOSED STRUCTURE: 8'x7'x40'-0" Box culvert  
Deck Width = 24'-0" Face to Face of Railing

PROJECT FINANCING: Force Account (**Local K-Funds**)

REASON: Structurally Deficient, Posted Load Limit

CONTRACTOR: County Crew