

KIDRON ROAD BRIDGE

BRIDGE No: SUG-CR52-0.98

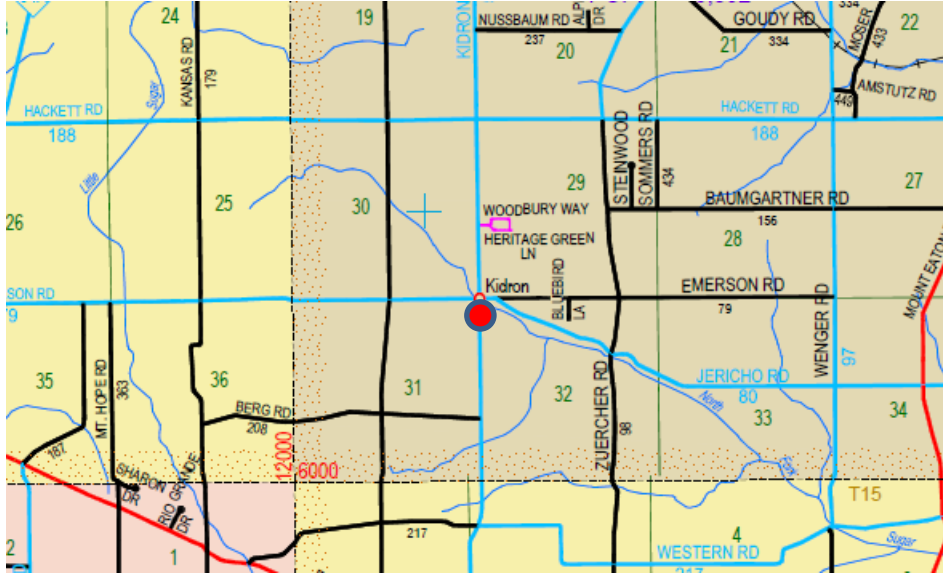

SOUTH APPROACH



ELEVATION

LOCATION: Kidron Road; 100 ft. South of Emerson Rd. (CR 79) over North Fork

EXISTING STRUCTURE: 20'-0" Single Span Reinforced Concrete Slab on Spread Footing
Roadway Width = 24.2' Curb to Curb; Deck Width Out-to-Out = 26.5'

PROPOSED STRUCTURE: 20' X 6' X 79'-6" Precast Reinforced Concrete Box Culvert
Roadway Width = 26'-0" Curb to Curb

PROJECT FINANCING: Estimated Contract Price - \$310,000.00; **(OPWC State Funds & Local K-Funds)**

REASON: Replace a Posted 11 Ton Load Limited and Structurally Deficient

CONTRACTOR: To be advertised for bid