

KANSAS ROAD BRIDGE

BRIDGE No: EAS-TR179-2.59

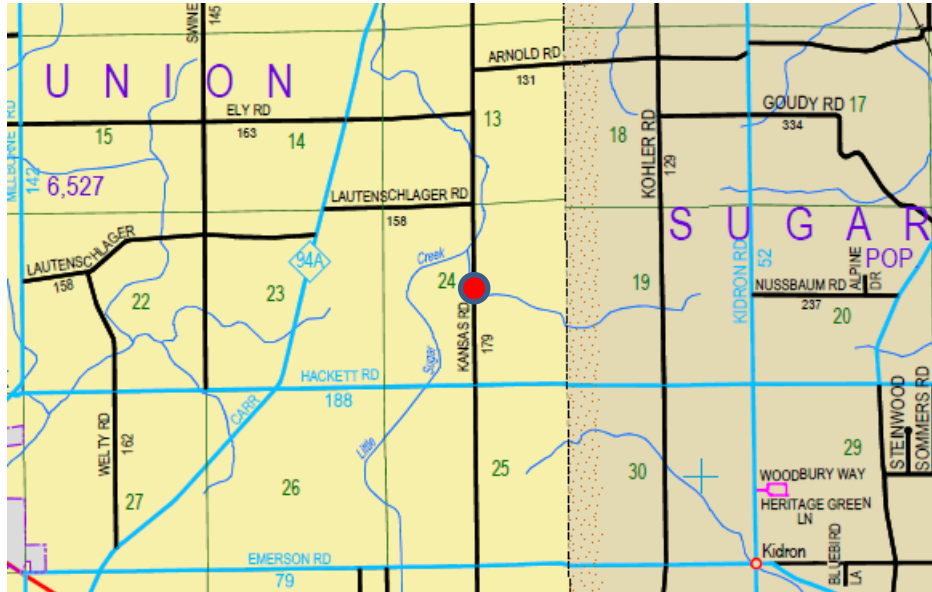

SOUTH APPROACH



ELEVATION

LOCATION: Kansas Road; 0.5 Mile north Of Hackett Rd. (CR 188) Over Branch of Little Sugar Creek

EXISTING STRUCTURE: 10'-0" Single Span Wood Deck on Steel Beams, Supported on Railroad Piles with Wood Backings;
Deck Width = 19.9' Face to Face of Railing

PROPOSED STRUCTURE: 14' X 4' X 58'-0" Precast Reinforced Concrete Box Culvert;
Deck Width = 26'-0" F/F of Railing

PROJECT FINANCING: Force Account (**Local K-Funds**)

REASON: Structurally Deficient

CONTRACTOR: County Crew